

# GLASS ATRIUM TEN THIRTY

Architect  
Client  
Location  
Year

OEVERZAAIJER ARCHITECTUUR EN STEDEBOUW  
KOOPMANS BOUW BV  
NETHERLANDS, AMSTELVEEN  
2015

07309

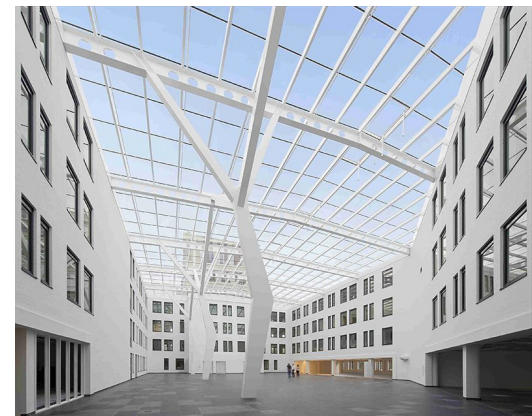
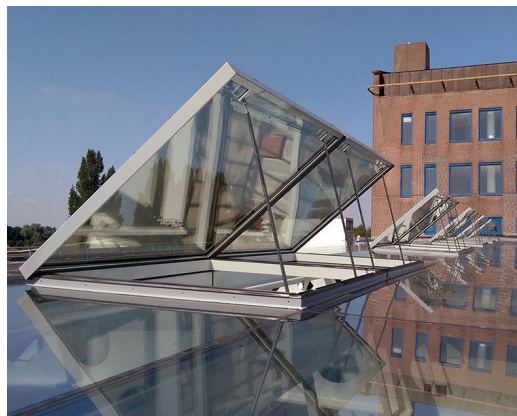
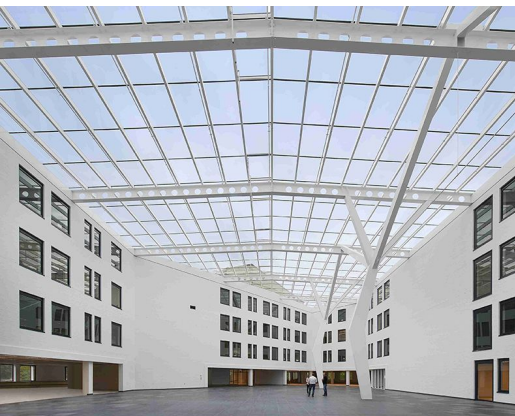

The former head office of KPMG in The Netherlands (project TenThirty) located on office park the Bovenlanden in Amstelveen has been renovated and refurbished to become the new head office for Atos Benelux & The Nordics, who signed a long term tenancy agreement with the owner of the building, Commerz Real Investmentgesellschaft (CRI). The project is characterized by a large courtyard for which Octatube has realised a glass roof structure.

The glass and steel roof consists of a main structure of castellated steel beams spanning 26 meters, supported by three tree-shaped columns. The columns are composed of tapered steel hollow sections interconnected and fixed to the castellated beams by means of invisible bolted connections. The secondary structure is a continuous purlin system for the fixation of more than 400 double glass units with a total surface of 1100 square meters.

**octatube**