

HAUS DES HANDWERKS

Architect
Client
Location
Year

SEVERAIN ARCHITECTS
HAUS DES HANDWERKS
GERMANY, MAINZ
2001

04903

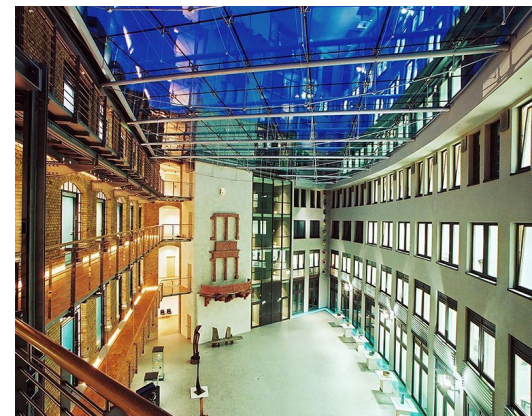
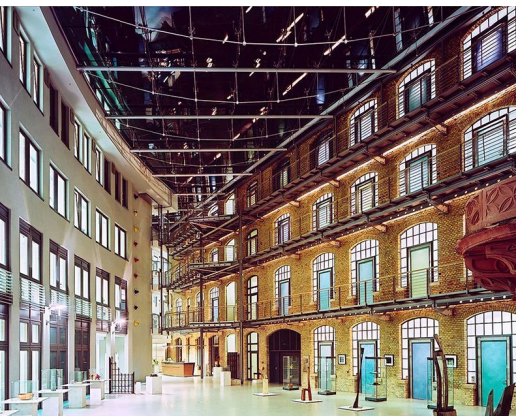
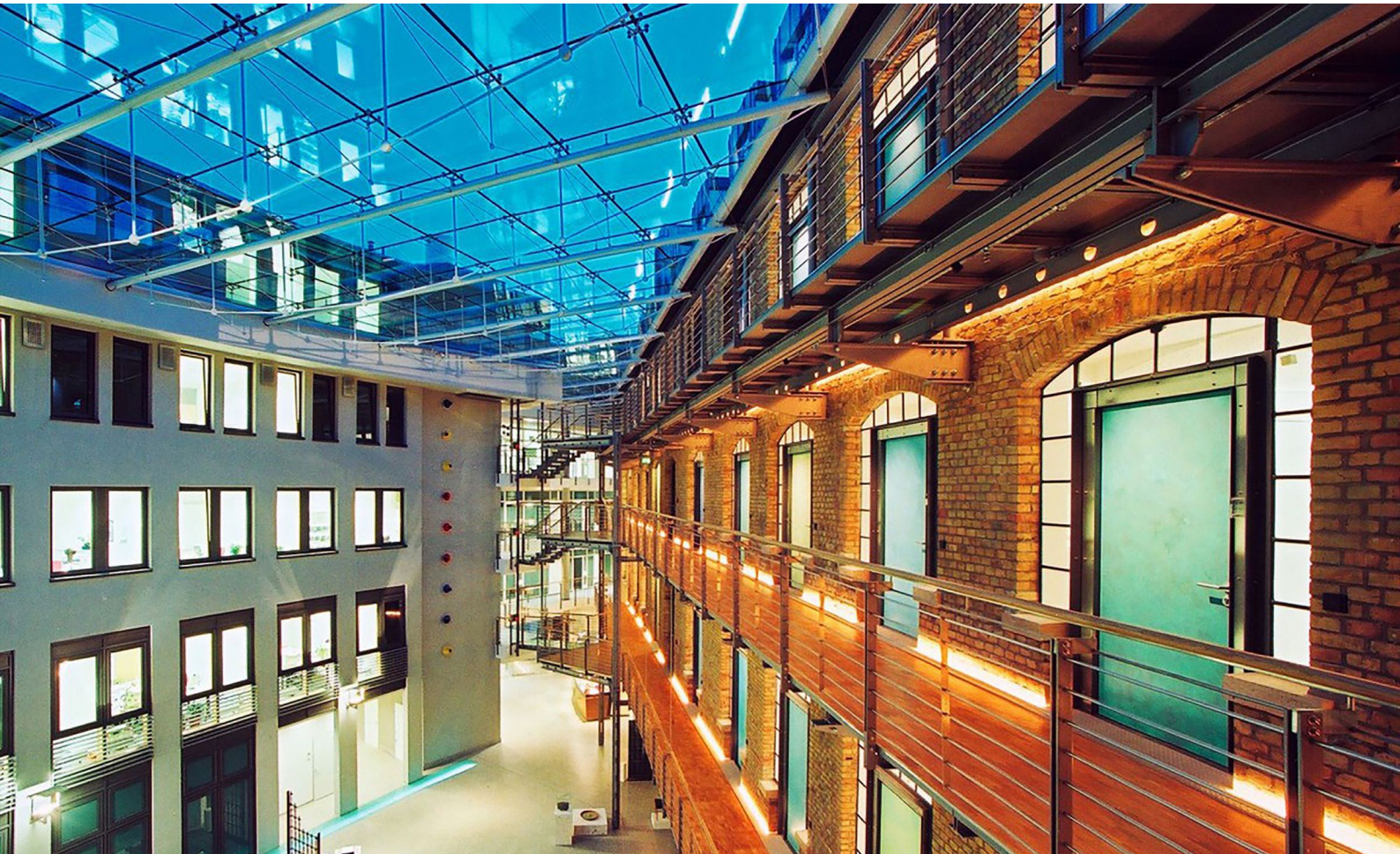

The Haus des Handwerks is a complex of redeveloped buildings. The open space in between the buildings has a complex floor plan and has been covered by a transparent glass roof on a filigrain steel construction. This atrium is supported by four meters long round stainless steel bars with a 3D tensegrity truss underneath. Half of the stainless steel cast glass-nodes are attached with an adjustable screwed connection.

The glass-nodes in between the trusses are supported by stainless steel tensile rods, that are spanning in between the main trusses. The dimensions of the double glass units are 2 by 2 meters. The glass is walkable and can carry a significant snow load (under the German building codes).