

ABN AMRO KONINGSKADE

Architect
Client
Location
Year

TENW ARCHITECTEN
DE KOK BOUWGROEP
NETHERLANDS, THE HAGUE
2017

07499

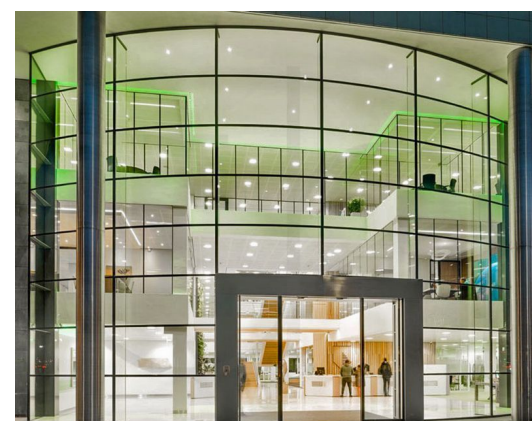
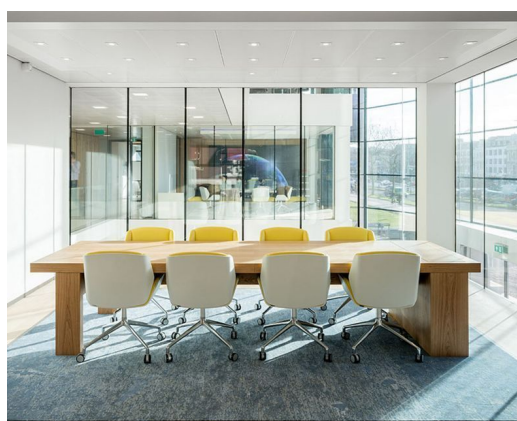
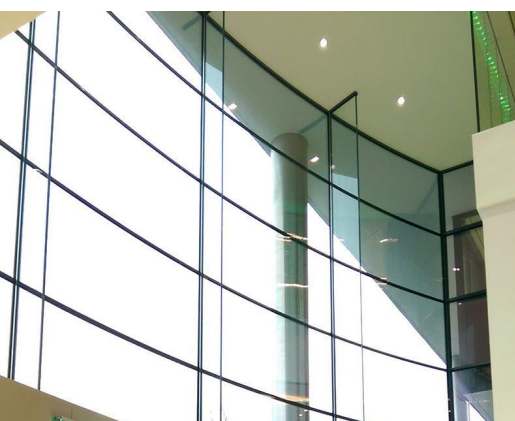

ABN Amro's new regional head office is featured by a fully glazed and bent entrance façade. The entrance is situated at the Koningskade, directly visible for everybody entering the city of The Hague by car. They notice the façade has a green hue, which has been processed in the glass upon special request from the client.

The new glass entrance makes the building easy to recognize, while the bent glass increases the sense of accessibility. The project is designed by TenW architecten, who enhanced the sustainability of the former Chamber of Commerce building significantly.

octatube